

### Features

- 18-gauge stainless steel
- Top-mount
- Double (equal) compartment
- Includes installation hardware
- 4-hole (-4), 3-hole (-3), or single-hole (-1)
- 33" (838 mm) x 22" (559 mm)

### TOP-MOUNT KITCHEN SINK K-3373

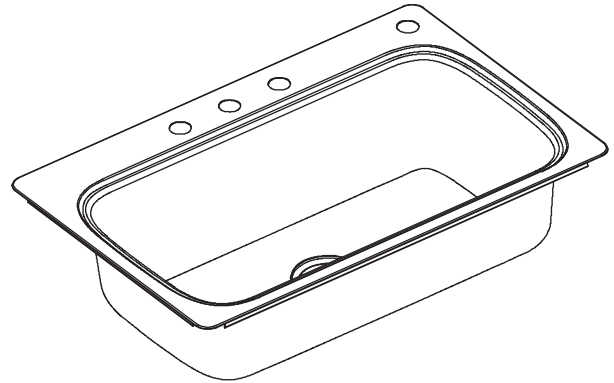

### Codes/Standards Applicable

Specified model meets or exceeds the following:

- ASME A112.19.3/CSA B45.4

### Colors/Finishes

- NA: None applicable

### Accessories

- CP: Polished Chrome
- ST: Stainless Steel
- NA: None applicable
- Other: Refer to Price Book for additional colors/finishes

### Specified Model

Model	Description	Colors/Finishes
K-3373-4	Top-mount kitchen sink – 4-hole	<input type="checkbox"/> NA
K-3373-3	Top-mount kitchen sink – 3-hole	<input type="checkbox"/> NA
K-3373-1	Top-mount kitchen sink – single-hole	<input type="checkbox"/> NA

Optional Accessories		
K-3119	Hardwood cutting board	<input type="checkbox"/> NA
K-3133	Stainless steel bottom bowl rack	<input type="checkbox"/> ST
K-8801	Duostrainer® sink strainer	<input type="checkbox"/> CP <input type="checkbox"/> Other_____
K-8813	Stainless steel sink strainer with tailpiece	<input type="checkbox"/> CP
K-8814	Stainless steel sink strainer, less tailpiece	<input type="checkbox"/> CP

### Product Specification

The top-mount kitchen sink shall be made of 18 gauge stainless steel. Sink shall be 33" (838 mm) in length and 22" (559 mm) in width. Sink shall be single compartment. Sink shall be 4-hole (-4), 3-hole (-3), or single-hole (-1). Sink shall include installation hardware. Sink shall be Kohler Model K-3373-\_\_\_\_\_-NA.

## Technical Information

Fixture*:	
Bowl area	29-1/2" (749 mm) x 15-3/4" (400 mm)
Water depth	8" (203 mm)
Drain hole	Ø 3-5/8" (92 mm)
Faucet holes	Ø 1-7/16" (37 mm)
*Approximate measurements for comparison only.	
Included components:	
Fastener pack	1023180

## Installation Notes

Install this product according to the installation guide.

Cut-out is 32-1/2" (826 mm) x 21-1/2" (546 mm) with 3/4" (19 mm) radius corners.

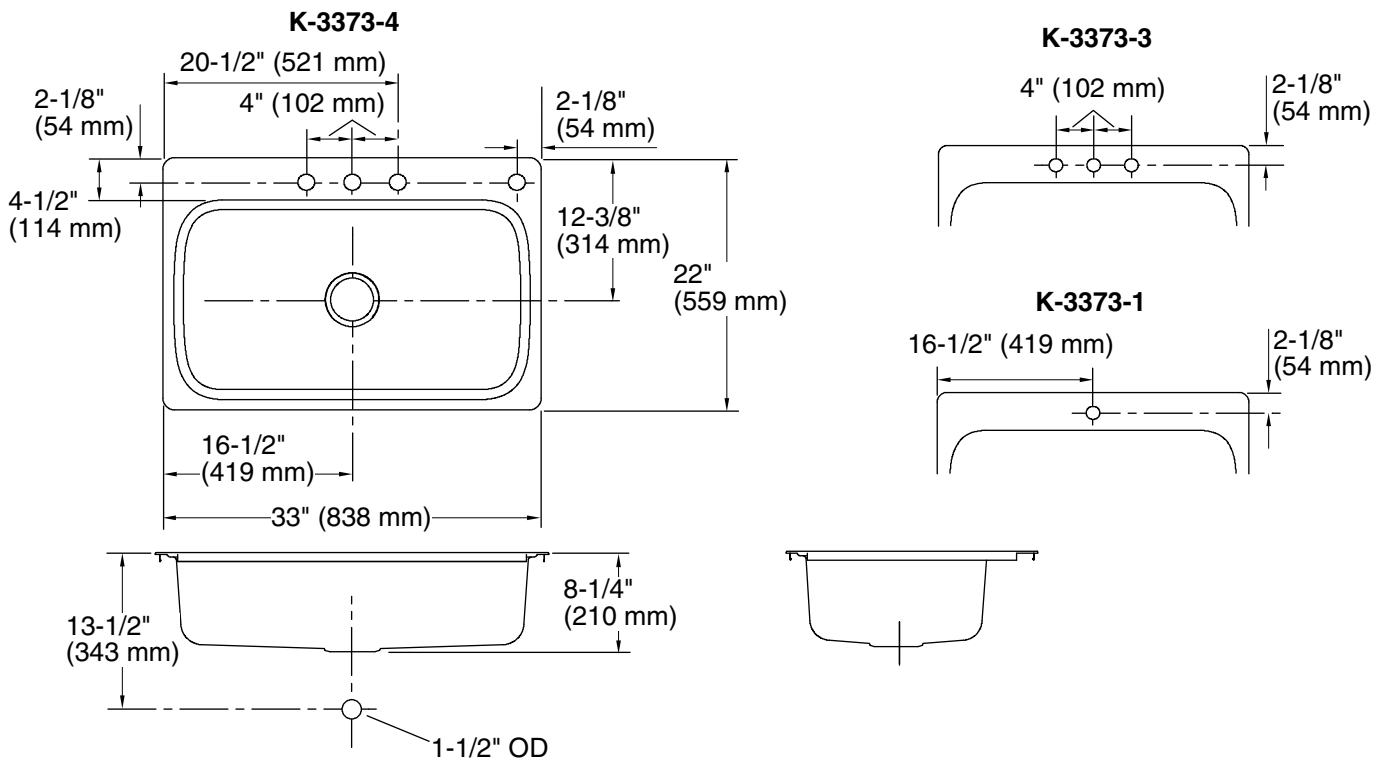

## Product Diagram